

NOTE:
This schedule forms part of the Official Plan and must be read together with the text.

Parts of this Schedule are currently pending approval. Please Refer to Figure 1 in the Preamble.

*Note:
The exact alignment of Queen Street is conceptual and is to be determined through a Class Environmental Assessment in accordance with the policies of Section F6.4.1.10 of this Plan.

- | | | | | |
|--|------------------------|------------------------|---------------------------------|-----------------------|
| Urban Area | Commuter Rail Corridor | Minor Arterial | Proposed Local Road | Exterior Roads |
| Hamlet Area | Rapid Transit Corridor | Major Arterial | Proposed Collector | Railway Line |
| Rural Cluster Area | Local Road | Multi-purpose Arterial | Proposed Multi-purpose Arterial | Major Transit Station |
| Town of Halton Hills Boundary | Employment Road | Provincial Freeway | | |
| HPBATS/GTA West Corridor Protection Area | Collector | Provincial Highway | | |

DECEMBER 31, 2020

CONSOLIDATION

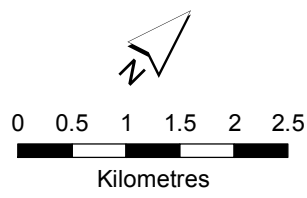

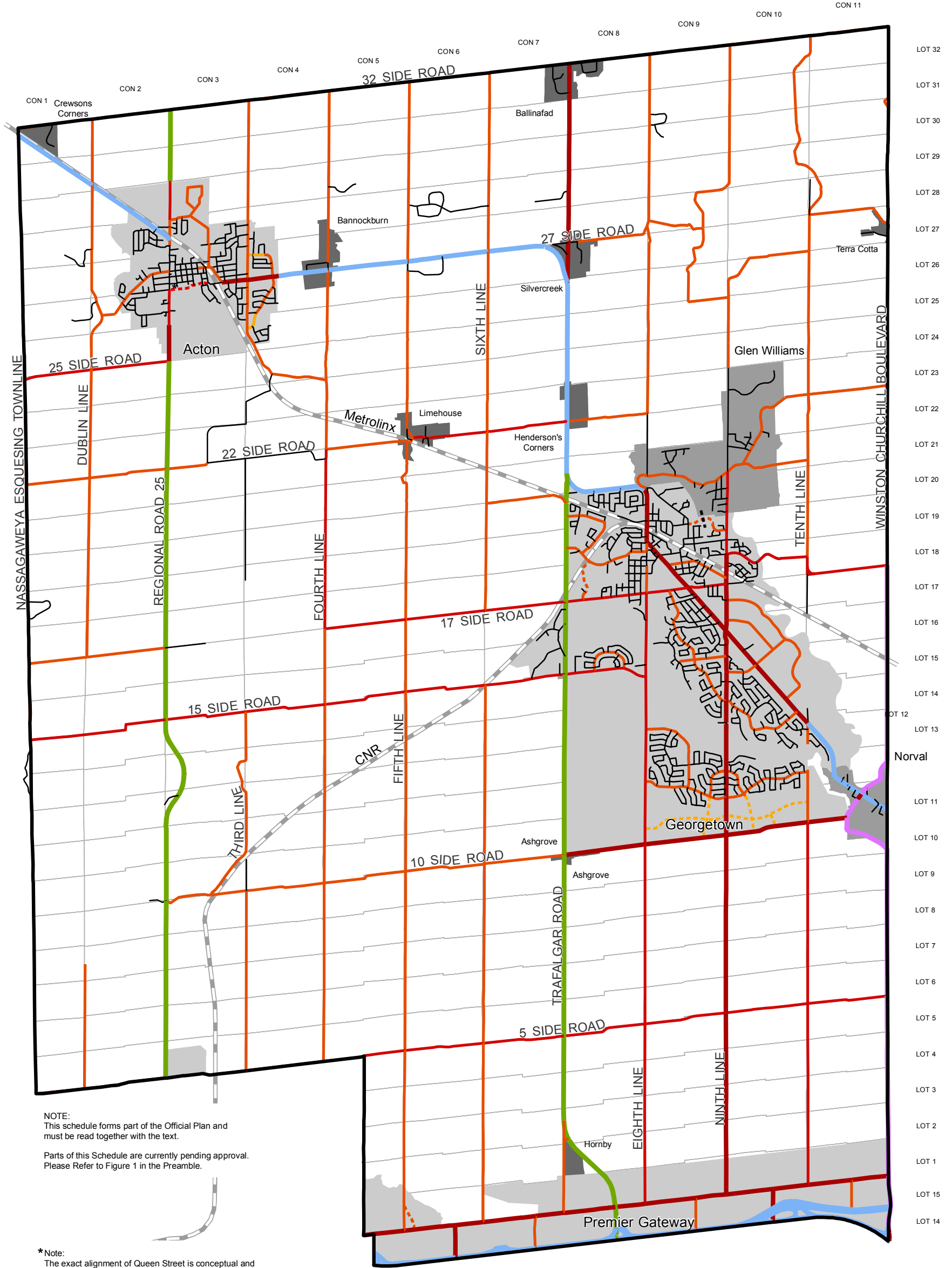

NOTE:
This schedule forms part of the Official Plan and must be read together with the text.
Parts of this Schedule are currently pending approval. Please Refer to Figure 1 in the Preamble.

*Note:
The exact alignment of Queen Street is conceptual and is to be determined through a Class Environmental Assessment in accordance with the policies of Section F6.4.1.10 of this Plan.

Urban Area	20 metre	35 metre	Proposed 20 metre	Exterior Roads
Hamlet Area	23 metre	36 metre	Proposed 23 metre	Railway Line
Rural Cluster Area	26 metre	42 metre	Proposed 26 metre	
Town of Halton Hills Boundary	30 metre	Provincial	Proposed 30 metre	

DECEMBER 31, 2020
CONSOLIDATION

