

user: oclm, file: L:\LPL_P\Projects\2025-020 - 97 Bower Street Acton, SPA11 (Zoning Phase)CAD\2025-020_250728_R00_ZBA.dwg, plot: Sep 02, 2025 - 9:33am

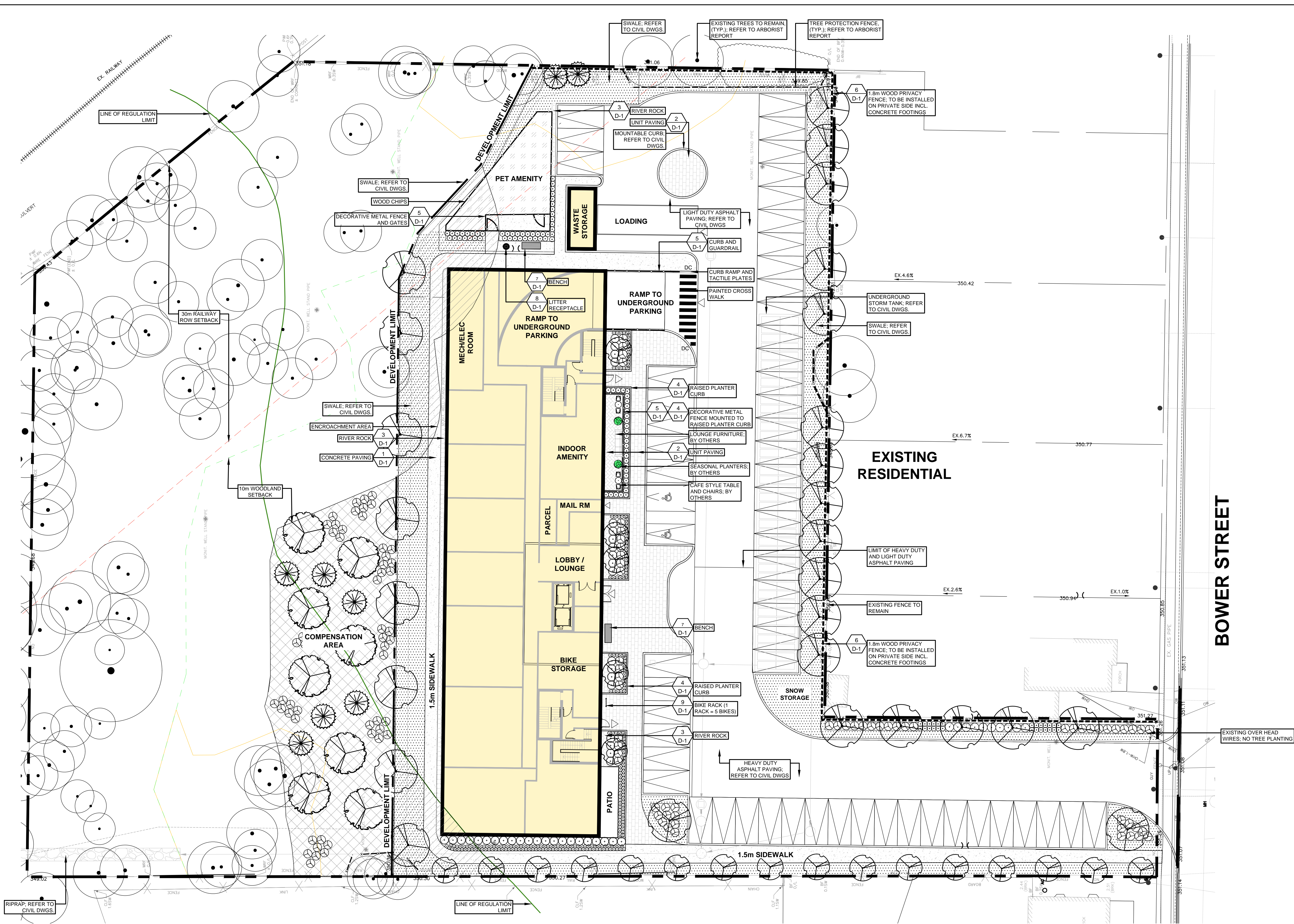

- LEGEND:**
- PROPERTY LINE
 - 30m RAILWAY ROW SETBACK
 - 10m WOODLAND SETBACK
 - LINE OF REGULATION SETBACK
 - 'ELC_HR'
 - DECORATIVE METAL FENCE
 - 1.8m HT. WOOD PRIVACY FENCE
 - TREE PROTECTION FENCE
 - CONCRETE PAVING
 - UNIT PAVING
 - RIVER ROCK
 - WOOD CHIPS
 - SOD
 - COMPENSATION AREA
 - EXISTING TREE TO REMAIN
 - PROPOSED DECIDUOUS TREE
 - PROPOSED CONIFEROUS TREE
 - PROPOSED SHRUBS AND PERENNIALS
 - COMPENSATION AREA PLANTING

NO.	ISSUED FOR ZBA SUBMISSION	9/2/2025	OC
REV.	REVISION	DATE	BY

THESE DRAWINGS ARE THE PROPERTY OF LANDSCAPE PLANNING LIMITED AND SHALL NOT BE ALTERED, MODIFIED, REVISED OR CHANGED WITHOUT THE WRITTEN CONSENT OF LANDSCAPE PLANNING LIMITED. SEAL IS NOT VALID WITHOUT SIGNATURE OF THE LANDSCAPE ARCHITECT. DRAWINGS CANNOT BE USED FOR TENDER/CONSTRUCTION UNTIL SIGNED BY LANDSCAPE ARCHITECT.

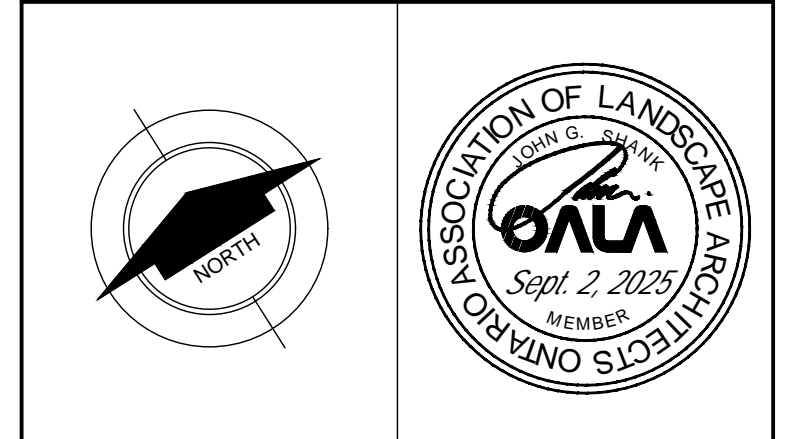

project number
2025-020



project title
97 BOWER STREET

TOWN OF ACTON
city file:
municipality: HALTON HILLS

drawing title
LANDSCAPE/SURFACE MATERIALS PLAN

drawn by OC	reviewed by JS	drawing number: L-1
date JUNE 2025	scale 1:200	

BOWER STREET

HALTON HILLS HYDRO

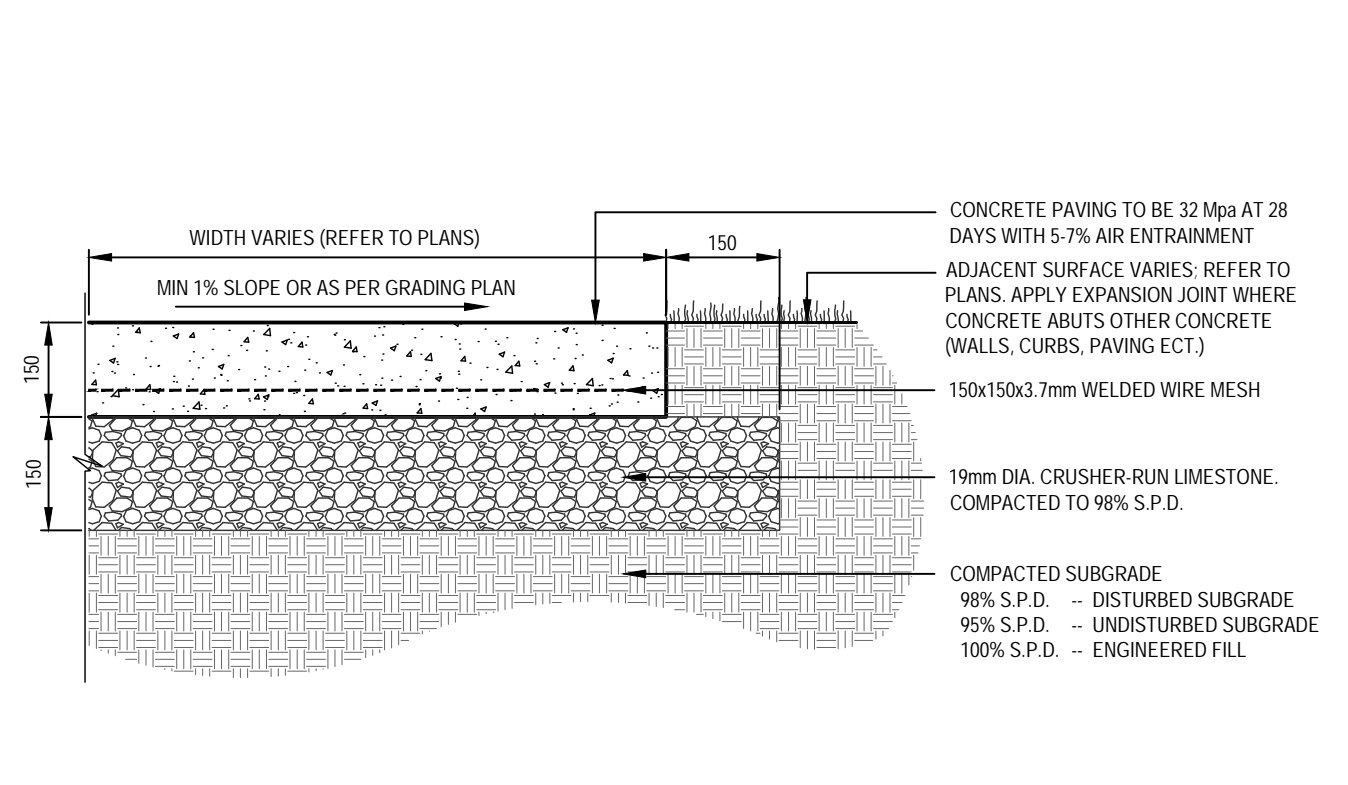

- NOTES:**
- CONTINUOUS BROOM FINISH ACROSS PATH AND SPRAYED WITH WHITE PIGMENT CURING COMPOUND
 - REFER TO JOINTING DETAIL FOR CONTROL AND EXPANSION JOINTS
 - CONCRETE PAVING TO HAVE SR VALUE OF 41
 - GRANULAR EDGE TO EXTEND MIN. 150mm BEYOND CONCRETE
 - CONCRETE EDGE TO BE FORMED UNIFORMLY, SMOOTH WITH CLEAN EDGES, WITHOUT LATERAL DEVIATIONS
 - SOD TO MEET & MATCH EXISTING GRADES, WITH SMOOTH TRANSITIONS AT A MAXIMUM SLOPE OF 3:1
 - GRADE WALKWAY WITH A MIN 1% CROSS-SLOPE OR AS DIRECTED ON SITE. PONDING WATER ON CONCRETE WALKWAYS WILL NOT BE ACCEPTED
 - ALL MEASUREMENTS ARE IN MILLIMETRES UNLESS STATED OTHERWISE.
 - REFER TO LANDSCAPE PLANS

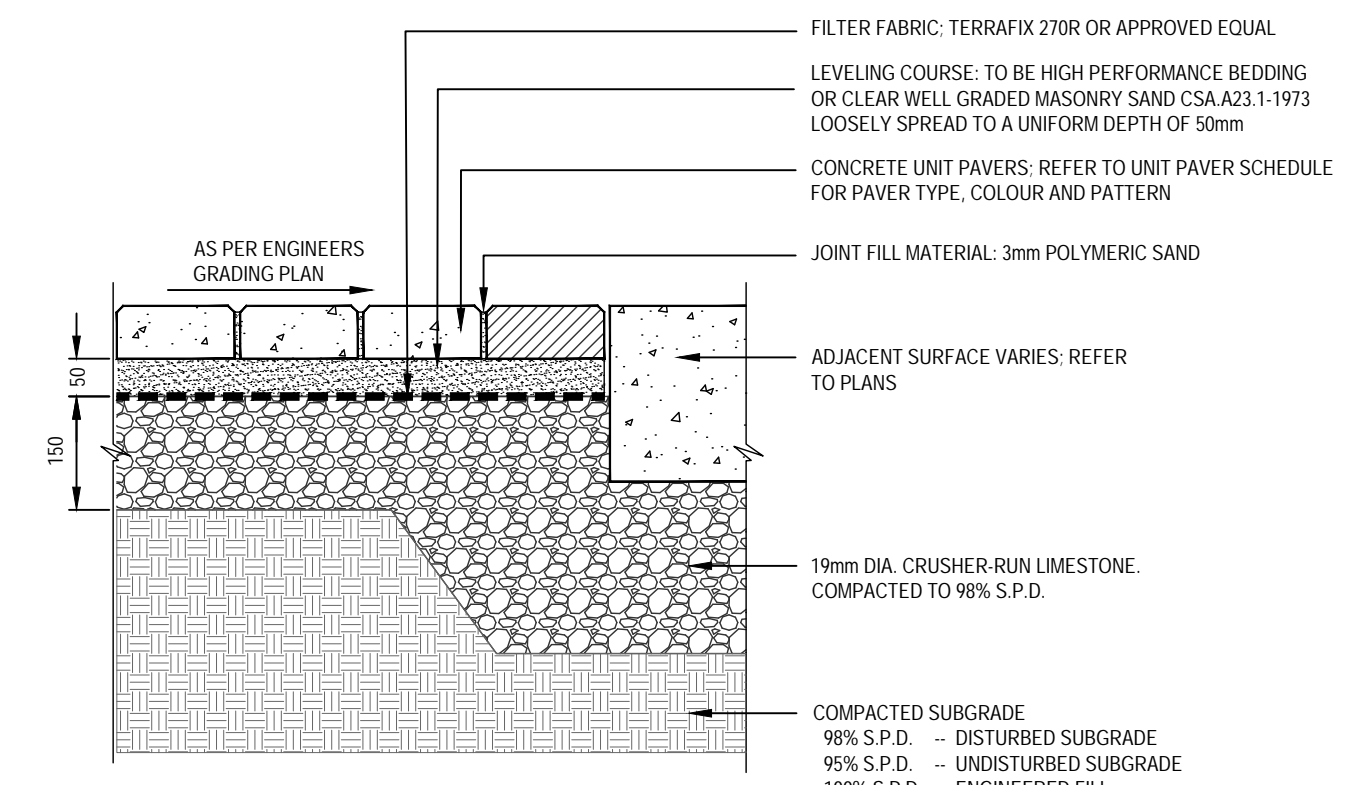

- NOTES:**
- WHERE REQUIRED, CUT UNIT PAVERS WITH AN APPROVED CUTTER TO FIT ACCURATELY, NEATLY AND WITHOUT DAMAGED EDGES.
 - AFTER LAYING UNIT PAVERS ON UNCOMPACTED, SCREENED SAND BEDDING OR HIGH PERFORMANCE BEDDING COURSE, COMPACT ENTIRE PAVED AREA TO ACHIEVE CONSOLIDATION OF THE BEDDING USING A SUITABLE PLATE COMPACTOR.
 - AFTER COMPACTING, JOINTING SAND SHALL BE SPREAD OVER PAVING AND SWEEP INTO JOINTS
 - GRADE WALKWAY WITH A MIN 2% CROSS-SLOPE OR AS DIRECTED ON SITE. PONDING WATER ON UNIT PAVING WILL NOT BE ACCEPTED
 - SOD TO MEET & MATCH EXISTING GRADES, WITH SMOOTH TRANSITIONS AT A MAXIMUM SLOPE OF 3:1
 - ALL MEASUREMENTS ARE IN MILLIMETRES UNLESS STATED OTHERWISE.
 - REFER TO PLANS

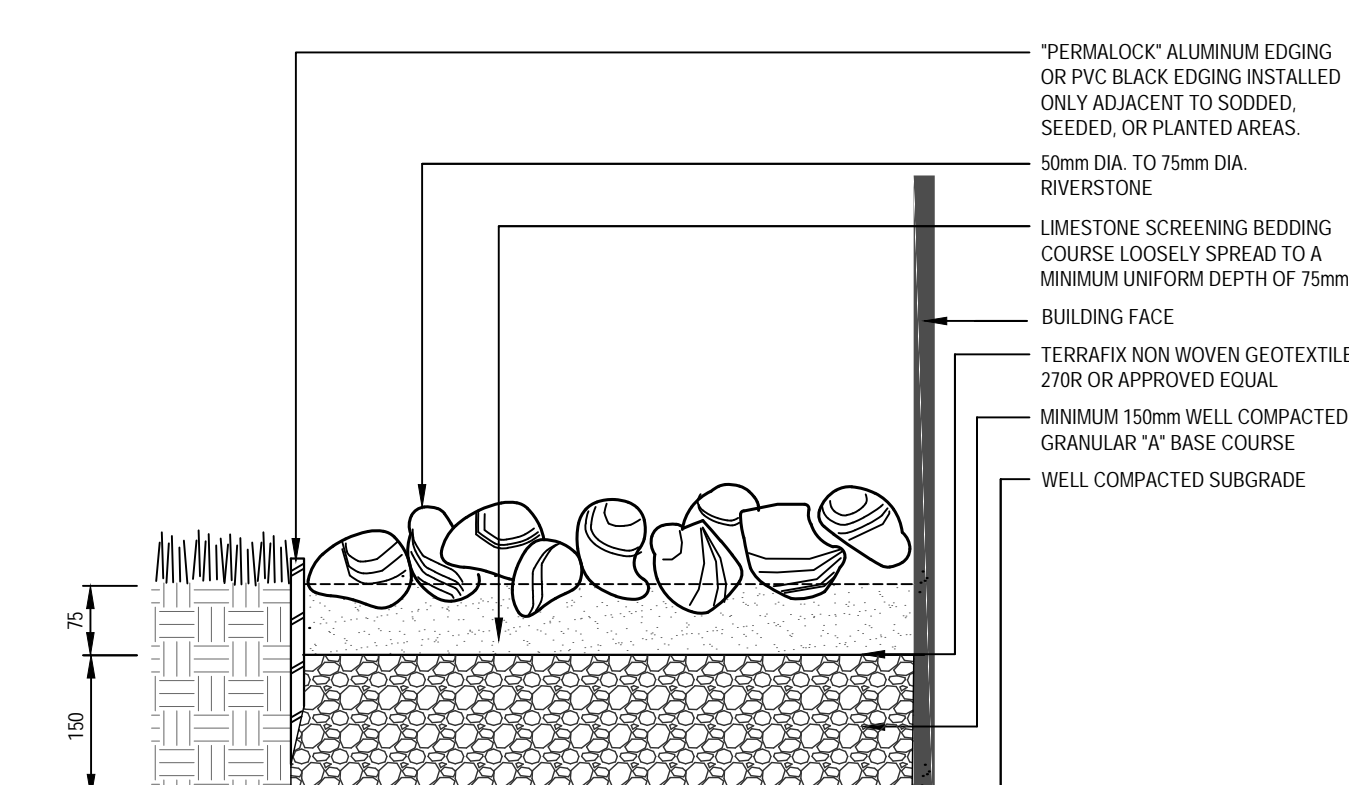

- NOTES:**
- RIVERSTONE SHALL BE FREE FROM CRACKS AND FISSURES, AND SHALL BE FREE FROM SAND CLAY AND OTHER DELETERIOUS MATERIAL
 - RIVERSTONE SHALL BE PLACED OVER THE LIMESTONE SCREENING BEDDING COURSE SUCH THAT AN OVERALL LEVEL APPEARANCE IS ACHIEVED WITHOUT VOIDS
 - RIVERSTONE SHALL THEN BE LIGHTLY COMPACTED TO EMBED INTO BEDDING COURSE

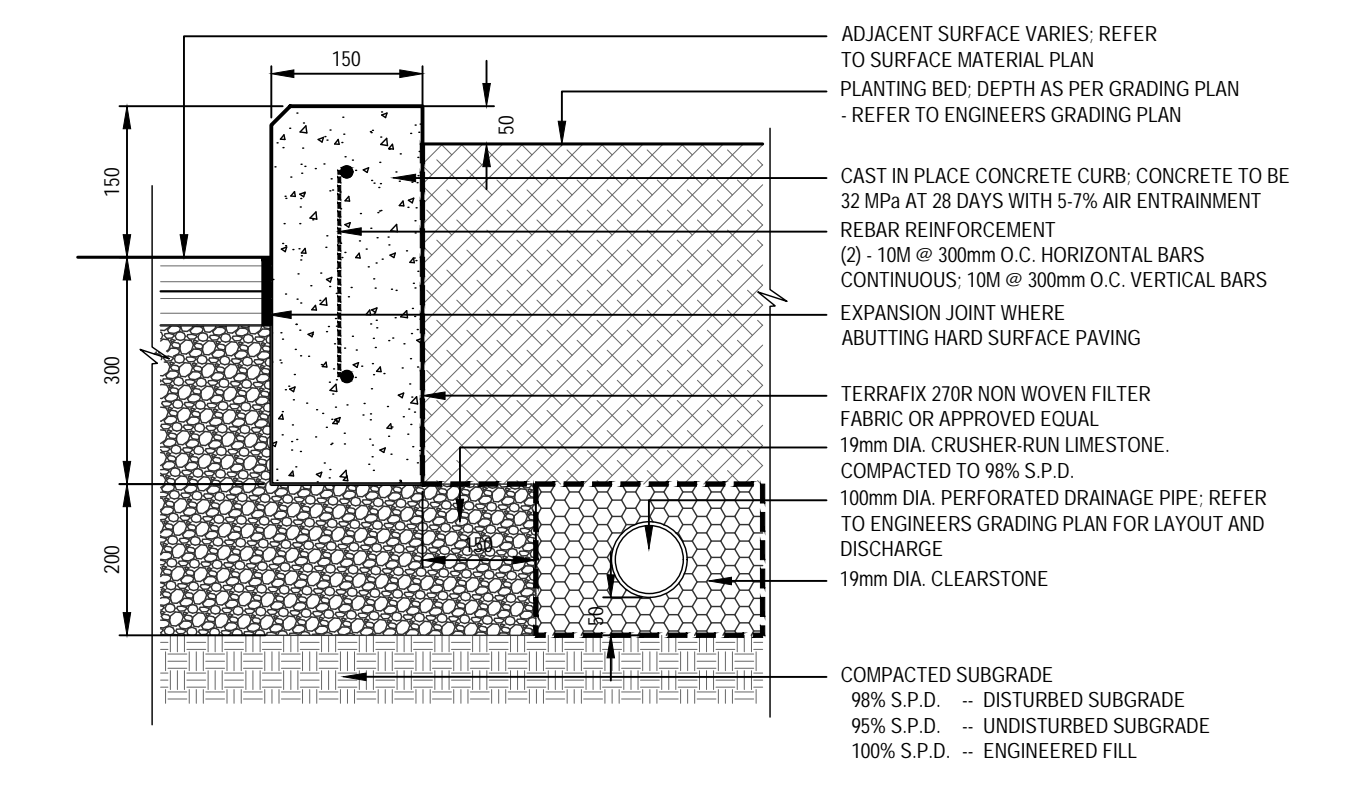

- NOTES:**
- GRANULAR BASE EDGE TO EXTEND MIN. 150mm BEYOND CONCRETE CURB
 - PROVIDE CONSULTANT WITH CONCRETE MIX DESIGN TWO (2) WEEKS PRIOR TO INSTALLATION. CONTRACTOR TO PROVIDE SAMPLES (TEST POURS) IN ACCORDANCE WITH SPECIFICATION
 - EXPANSION JOINTS TO BE PLACED EVERY 6000mm O.C.; SAW CUT CONTROL JOINTS TO BE PLACED EVERY 1500mm O.C.; EXPANSION JOINTS TO BE SEALED WITH POLYURETHANE CAULK, COLOUR TO MATCH CONCRETE
 - CURB TOP TO BE CONSTANT; REFER TO GRADING PLAN
 - CONSULTANT TO REVIEW & APPROVE CURB LAYOUT & FORMS PRIOR TO PLACEMENT OF CONCRETE
 - CONCRETE EDGE TO BE FORMED UNIFORMLY, SMOOTH WITH CLEAN EDGES, WITHOUT LATERAL DEVIATIONS
 - ALL MEASUREMENTS ARE IN MILLIMETRES UNLESS STATED OTHERWISE
 - REFER TO LANDSCAPE PLANS FOR LOCATION
 - REFER TO GRADING PLANS BY ENGINEER

1 CONCRETE PAVING
D-1 N.T.S.

2 UNIT PAVING
D-1 N.T.S.

3 RIVERSTONE
D-1 N.T.S.

4 RAISED PLANTER CURB
D-1 N.T.S.

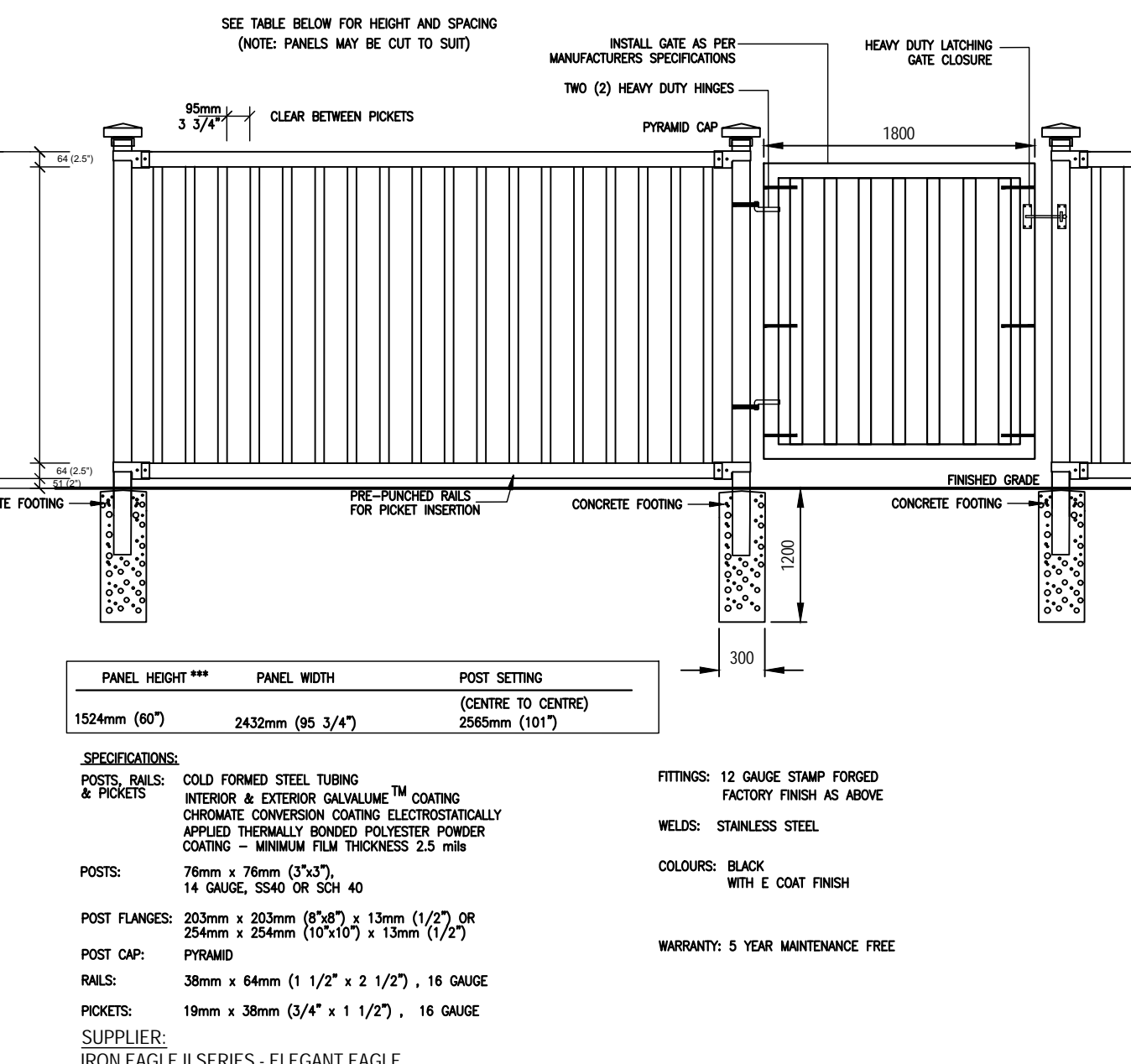

5 DECORATIVE METAL FENCE WITH GATE
D-1 N.T.S.

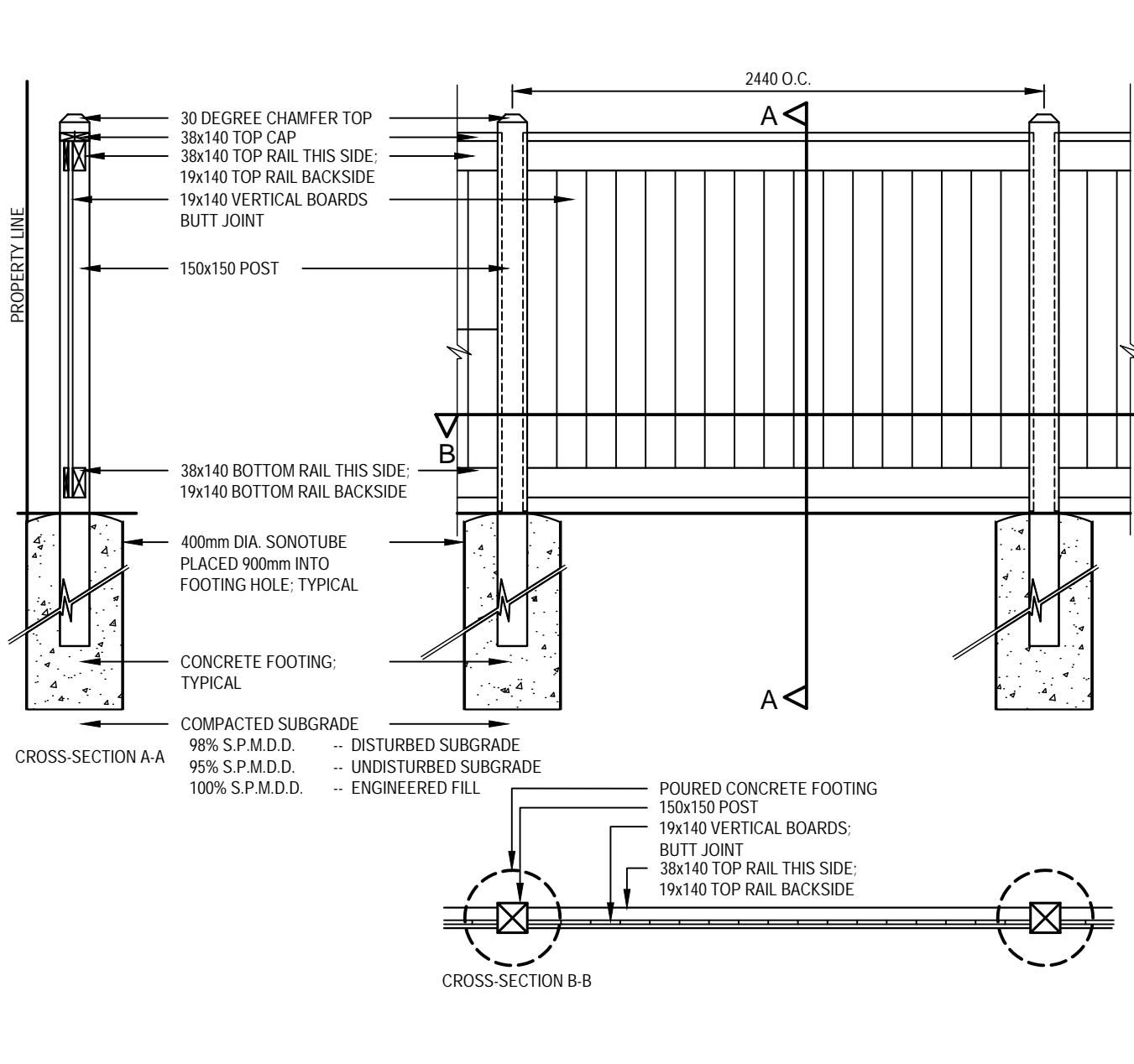

6 PRIVACY FENCE - CEDAR 1.8m h.t.
D-1 N.T.S.

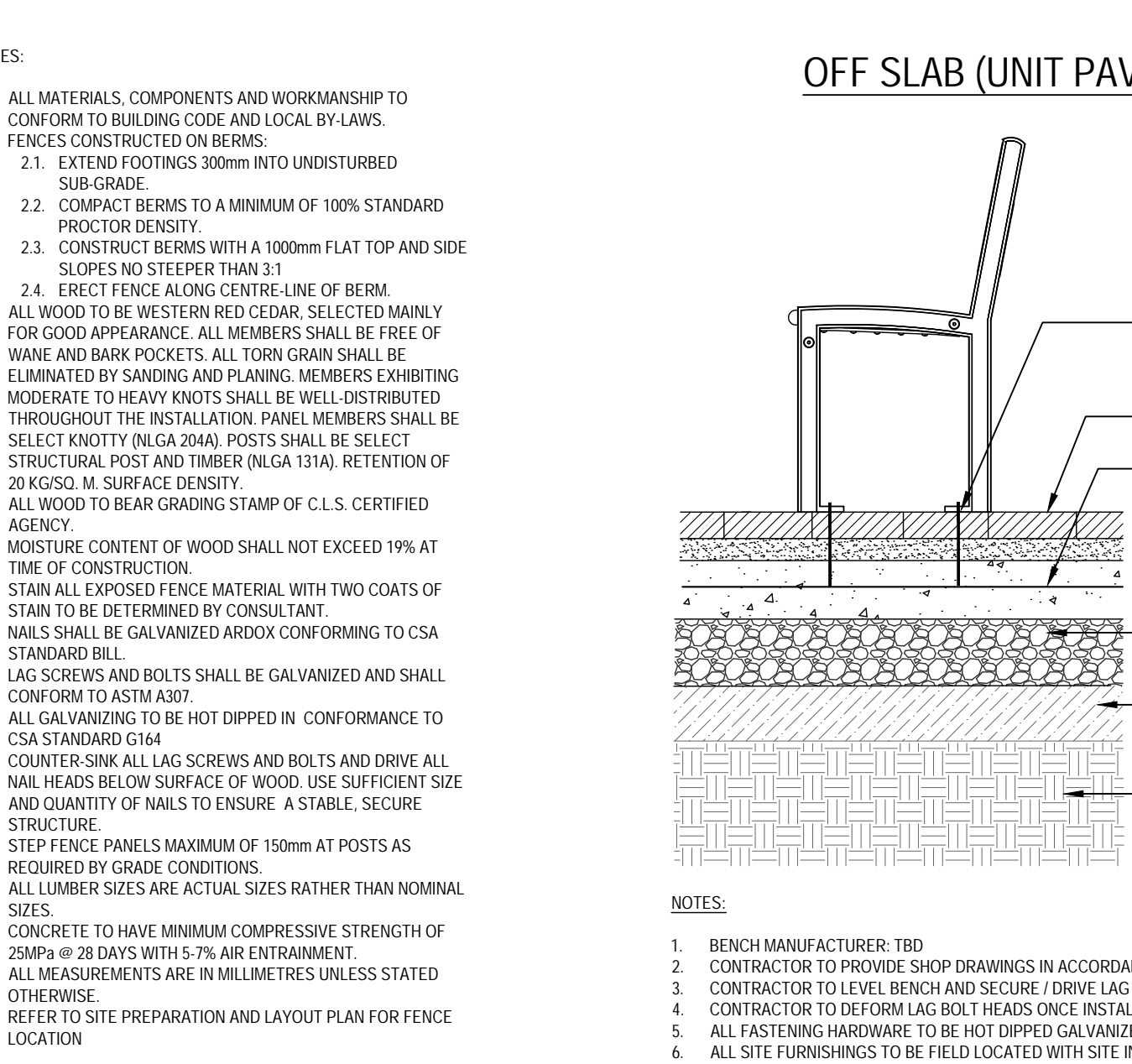

7 BENCH
D-1 N.T.S.

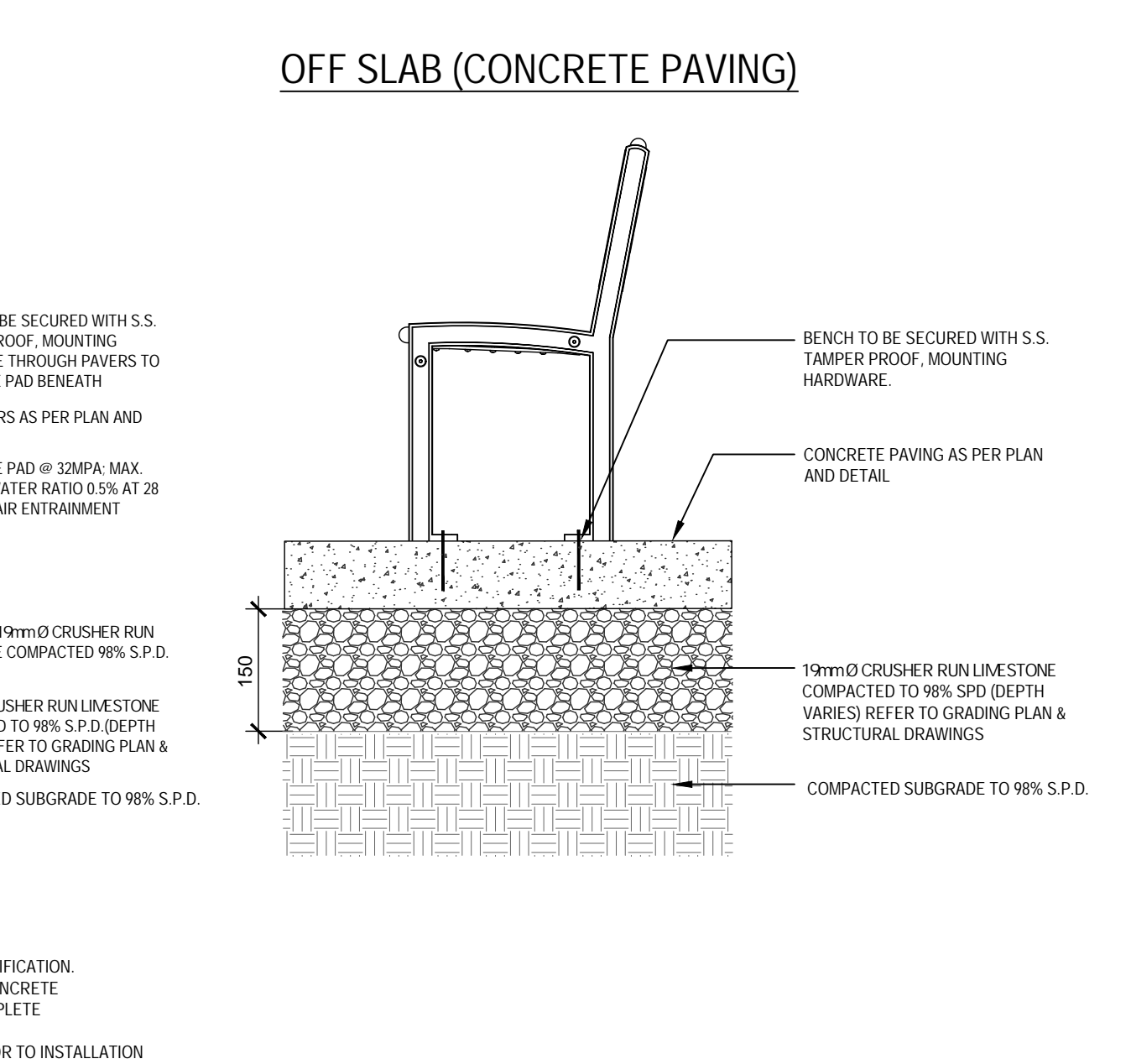

8 OFF SLAB (CONCRETE PAVING)
D-1 N.T.S.

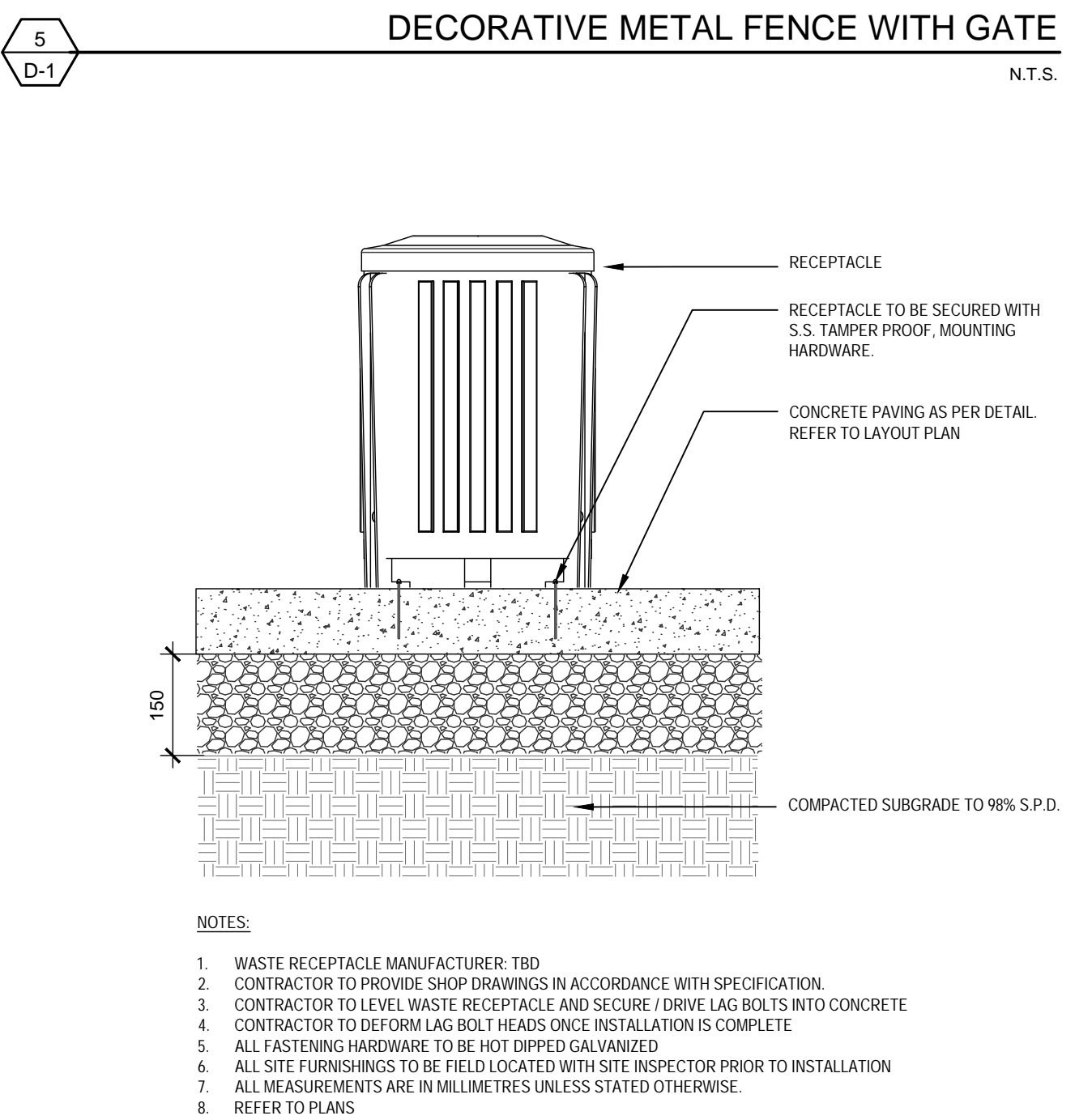

8 LITTER RECEPTACLE
D-1 N.T.S.

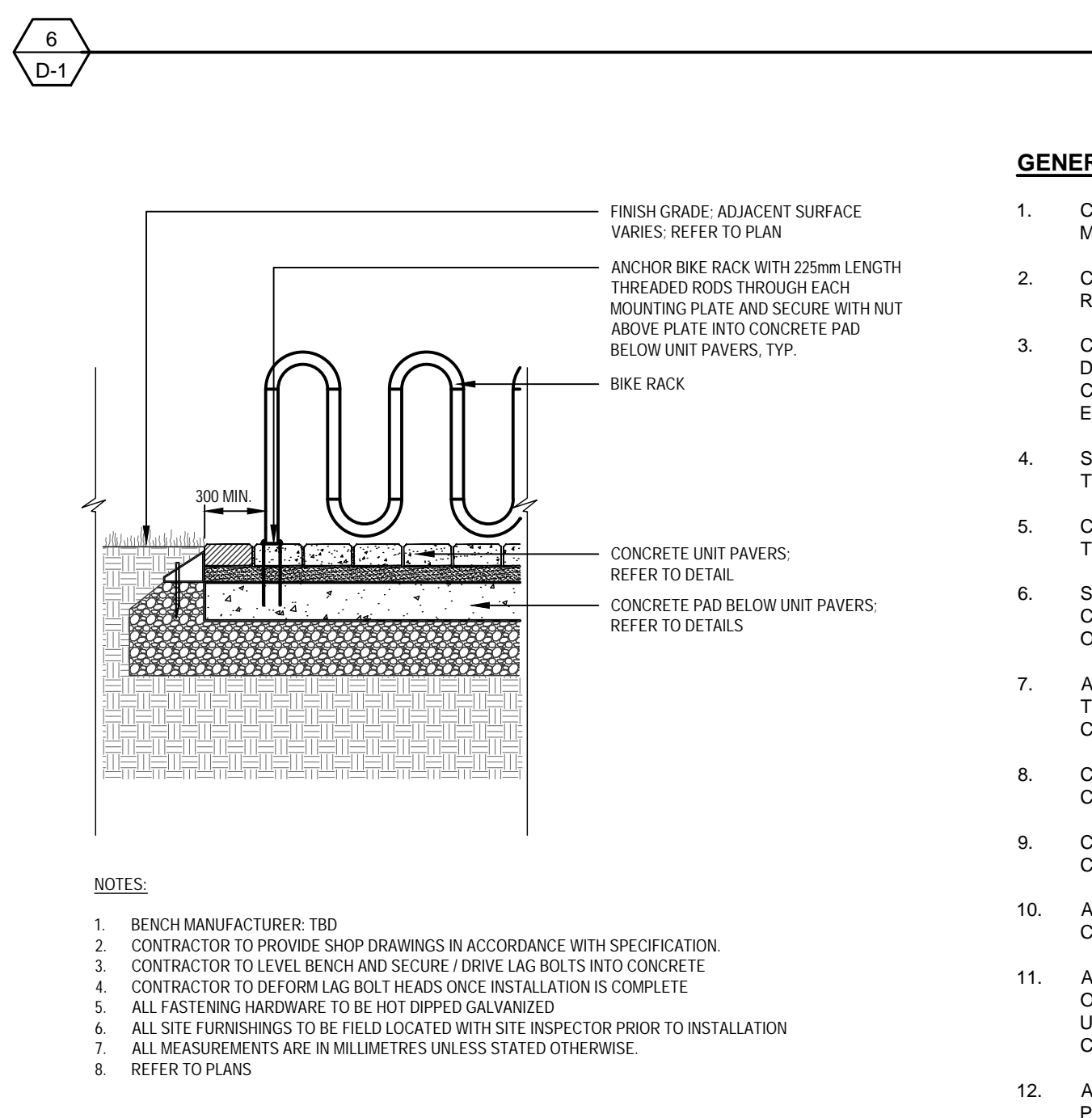

9 BIKE RACK
D-1 N.T.S.

- GENERAL NOTES:**
- CONTRACTOR SHALL BE REQUIRED TO HAVE A FLAGMAN DIRECTING ALL DELIVERIES OF MACHINERY OR MATERIALS TO THE SITE.
 - CONTRACTOR SHALL PROTECT ALL IRON BARS. ANY DISTURBED BARS SHALL BE REPLACED BY OWNER AT CONTRACTOR'S EXPENSE.
 - CONTRACTOR SHALL REVIEW AND VERIFY SITE GRADES AND REPORT ANY DISCREPANCIES TO THE LANDSCAPE ARCHITECT. COMMENCEMENT OF GRADING SHALL CONSTITUTE ACCEPTANCE OF SITE CONDITIONS; NO CLAIMS FOR EXTRAS WILL BE ENTERTAINED THEREAFTER.
 - STORAGE OF MATERIALS, VEHICLES AND EQUIPMENT SHALL NOT BE PERMITTED WITHIN THE MUNICIPAL ROAD ALLOWANCE.
 - CONTRACTOR SHALL BE RESPONSIBLE TO CLEAN ROADS DAILY TO THE SATISFACTION OF THE LANDSCAPE ARCHITECT.
 - SITE SHALL BE MAINTAINED IN A CLEAN AND ORDERLY STATE FOR THE DURATION OF CONSTRUCTION; ALL WORK SHALL BE PERFORMED IN ACCORDANCE WITH THE OCCUPATIONAL HEALTH AND SAFETY ACT.
 - ALL TEMPORARY PROTECTIVE & SEDIMENT CONTROL FENCING SHALL BE MAINTAINED BY THE CONTRACTOR TO THE SATISFACTION OF THE L.A. FOR THE DURATION OF CONSTRUCTION.
 - CONTRACTOR SHALL SUPPLY & INSTALL FILTER FABRIC PROTECTION ON ALL EXISTING CATCH BASINS, WATER REPAIR CHAMBERS, AND UTILITIES.
 - CONTRACTOR SHALL REPAIR AT HIS COST ANY DAMAGE ARISING DURING CONSTRUCTION.
 - ALL EXISTING VEGETATION TO BE RETAINED SHALL BE PROTECTED BY THE GENERAL CONTRACTOR FOR THE DURATION OF CONSTRUCTION.
 - ALL EXISTING UTILITIES SHOWN ON THE DRAWINGS ARE FOR REFERENCE PURPOSES ONLY. THE GENERAL CONTRACTOR SHALL CONTACT THE UTILITY COMPANIES FOR UTILITY STAKEOUT. THE CONTRACTOR SHALL BE RESPONSIBLE FOR ANY DAMAGES CAUSED TO EXISTING UTILITIES DURING CONSTRUCTION.
 - ALL CONSTRUCTION TO BE CARRIED OUT IN ACCORDANCE WITH THE MOST CURRENT PROVINCIAL AND MUNICIPAL STANDARDS AND SPECIFICATIONS.
 - THE CONDITION OF CURBS, SIDEWALKS, STREET TREES AND UTILITIES LOCATED WITHIN THE R.O.W. SHALL BE REVIEWED AND DOCUMENTED BETWEEN ALL PARTIES PRIOR TO THE START OF CONSTRUCTION.
 - DUST CONTROL:** CONTRACTOR SHALL TAKE ALL NECESSARY MEASURES TO CONTROL DUST ON THIS PROJECT SITE ON A DAILY BASIS AND TO THE SATISFACTION OF THE CONSULTANT.

- GENERAL PLANTING AND BED PREPARATION NOTES:**
- PLANT PERFORMANCE:**
- ALL PLANT MATERIAL SHALL BE NURSERY STOCK CONFORMING TO THE LATEST EDITION OF THE CANADIAN STANDARDS FOR NURSERY STOCK AS PUBLISHED BY THE CANADIAN NURSERY LANDSCAPE ASSOCIATION.
 - ALL PLANTS SHALL BE HEALTHY, VIGOROUS PLANTS, FREE FROM DEFECTS, DECAY, DISFIGURING ROOTS, SUN-SCALD INJURIES, BARK ABRASIONS, PLANT DISEASES AND PESTS AND ALL FORMS OF INFESTATIONS OR OBJECTIONABLE DISFIGUREMENTS.
 - ALL PLANTS SHALL BE TRUE TO NAME, SIZE, CONDITION AND QUANTITY AS PER PLAN AND PLANT LIST SPECIFICATIONS.
 - ALL PLANT MATERIAL SHALL BE UNWRAPPED PRIOR TO INSPECTION. THE LANDSCAPE ARCHITECT RESERVES THE RIGHT TO INSPECT ALL PLANT MATERIAL AND REJECT ALL MATERIAL THAT DOES NOT MEET THE STANDARDS LISTED HEREIN.
 - SUBSTITUTIONS WILL NOT BE ACCEPTED WITHOUT PRIOR WRITTEN REQUEST BY THE CONSULTING LANDSCAPE ARCHITECT. ADDITIONAL PLANT QUANTITIES WILL BE REQUIRED TO COMPENSATE FOR APPROVED REDUCTION IN SIZE DUE TO UNAVAILABILITY OF MATERIALS, TO THE SATISFACTION OF THE LANDSCAPE ARCHITECT.
 - ALL TREES SHALL BE OPEN-GROWN FOR WIND-FIRMNESS. TREES SHALL NOT BE LEANING OR HAVE SIGNIFICANT SWEEP, CROOK OR BEND. DECIDUOUS TREES SHALL HAVE APPROXIMATELY TWO-THIRDS OF THEIR TOTAL HEIGHT IN LIVING BRANCHES. ALL TREES SHALL HAVE GOOD CROWN SHAPE AND COLOUR (EVERGREENS) CHARACTERISTIC OF THEIR SPECIES. TREES SHALL HAVE A SINGLE DOMINANT LEADER WITH NO SIDE BRANCHES TALLER / LONGER THAN THE MAIN LEADER.
 - IF REQUIRED, TREES SHALL BE PROPERLY TARGET PRUNED (NEVER FLUSH CUT, TRIMMED, ROUNDED-OVER, HEGGED, TIPPED OR TOPPED) AND DEAD / DAMAGED BRANCHES SHALL BE REMOVED. BRANCHES THAT CROSS-OVER EACH OTHER OR RUB AGAINST EACH OTHER, CO-DOMINANT LEADERS, AND BRANCHES GROWING UPWARD INSIDE THE CROWN SHALL BE PROPERLY PRUNED. TREES SHALL NOT BE TREATED AT ANY TIME WITH WOUND PAINT.

- ALL TREES SHALL HAVE ROOT BALL SIZES THAT MEET OR EXCEED NURSERY STANDARDS. ROOT BALLS SHALL BE FIRM AND STRUCTURALLY INTEGRAL WITH THE TRUNK.
 - SHRUBS AND GROUND COVERS SHALL HAVE FULL, WELL BRANCHED CROWNS TYPICAL OF SPECIES OR VARIETY. ROOT SYSTEMS SHALL BE AMPLE, WELL-BALANCED AND FIBROUS, CAPABLE OF SUSTAINING VIGOROUS GROWTH. PLANTS THAT ARE WEAK OR THIN, UNDERSIZED, OR HAVE BEEN CUT BACK FROM LARGER GRADES TO MEET SPECIFICATIONS SHALL BE REJECTED.
 - ALL SOD SHALL BE TURFGRASS NURSERY SOD CONFORMING TO THE LATEST SPECIFICATIONS OF THE ONTARIO SOD ASSOCIATION AND THE THE NURSERY SOD GROWERS ASSOCIATION.
- TOPSOIL REQUIREMENTS:**
- SOD AND SEED: 150mm DEPTH
TOPSOIL MAKE UP: TOPSOIL SHALL BE A FERTILE, NATURAL LOAM, CAPABLE OF SUSTAINING HEALTHY GROWTH; CONTAINING A MINIMUM OF 4% ORGANIC MATTER FOR CLAY LOAMS AND 2% ORGANIC MATTER FOR SANDY LOAM, TO A MAXIMUM OF 25% BY VOLUME. TOPSOIL SHALL BE LOOSE AND FRABLE, FREE OF SUBSOIL, CLAY LUMPS, STONES, ROOTS OR ANY OTHER DELETERIOUS MATERIAL GREATER THAN 50MM DIAMETER. TOPSOIL SHALL BE FREE OF ALL LITTER AND TOXIC MATERIALS THAT MAY BE HARMFUL TO PLANT GROWTH. TOPSOIL CONTAINING SOD CLUMPS, CRABGRASS, COUCHGRASS OR OTHER NOXIOUS WEEDS IS NOT ACCEPTABLE. TOPSOIL SHALL NOT BE DELIVERED OR PLACED IN A FROZEN OR EXCESSIVELY WET CONDITION. TOPSOIL ACIDITY / ALKALINITY SHALL BE IN THE RANGE OF 6.0PH TO 7.5PH.
 - TREE PITS: 600mm DEPTH TRIPLE MIX
 - CONTINUOUS TREE PITS: 1000mm DEPTH TRIPLE MIX
 - CONTINUOUS BEDS: 500mm DEPTH TRIPLE MIX
- SERVICES, STAKEOUTS & PLANTING ADJUSTMENTS**
- CONTRACTORS SHALL OBTAIN STAKEOUTS FROM ALL UTILITIES PRIOR TO LANDSCAPE INSTALLATIONS.

NO.	REVISION	DATE	BY

ISSUED FOR ZBA SUBMISSION 9/2/2025 OC

THESE DRAWINGS ARE THE PROPERTY OF LANDSCAPE PLANNING LIMITED AND SHALL NOT BE ALTERED, MODIFIED, REVISED OR CHANGED WITHOUT THE WRITTEN CONSENT OF LANDSCAPE PLANNING LIMITED. SEAL IS NOT VALID WITHOUT SIGNATURE OF THE LANDSCAPE ARCHITECT. DRAWINGS CANNOT BE USED FOR TENDER/CONSTRUCTION UNTIL SIGNED BY LANDSCAPE ARCHITECT.



project number
2025-020



project title
97 BOWER STREET

TOWN OF ACTON
city file: -
municipality: HALTON HILLS
drawing title

DETAILS

drawn by OC	reviewed by JS	drawing number: D-1
date JUNE 2025	scale AS SHOWN	